

Performance Curve

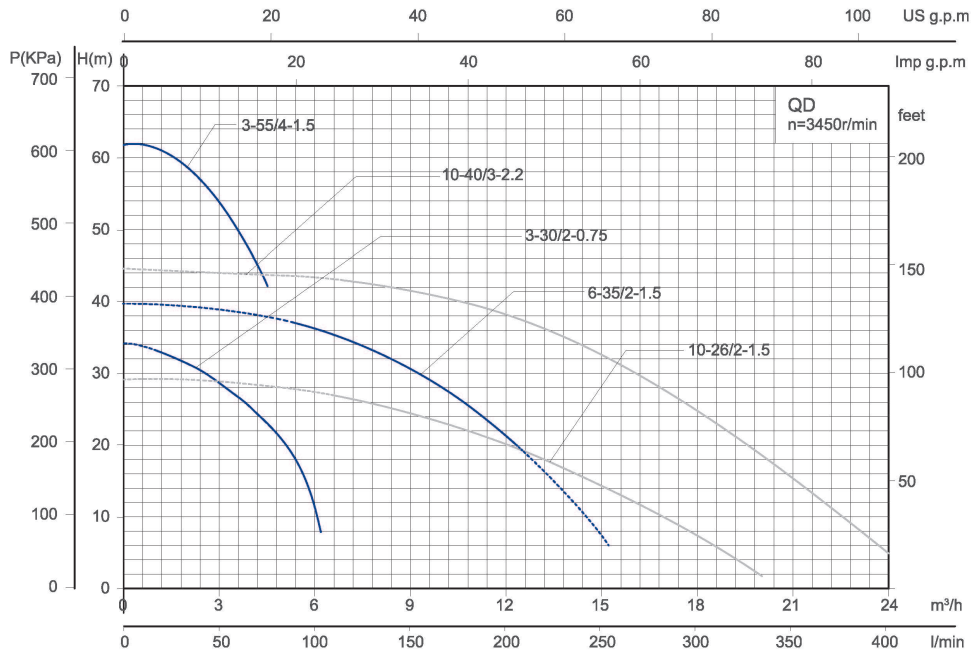

Model	Power		Rate Current (A)	Max. Flow (m³/h)	Max. Head (m)	Head Range (m)	Cable line (m)	Dim.mm (L×B×H)	G.W. (kg)	20' Loading Qty. (pcs)
	kW	HP								
QD3-30/2-0.75(220V/60Hz)	0.750	1.00	5.2	6.0	33.0	0 ~ 33	3×1-15	495×220×235	24.0	1094
QD3-55/3-1.5J(220V/60Hz)	1.500	2.00	9.5	4.0	62.0	0 ~ 62	3×1-15	610×220×235	32.0	888
QD10-26/2-1.5J(220V/60Hz)	1.500	2.00	9.5	20.0	30.0	0 ~ 30	3×1-15	580×220×235	30.0	934
QD6-35/2-1.5J(220V/60Hz)	1.500	2.00	9.5	15.0	40.0	0 ~ 40	3×1-15	580×220×235	30.0	934
QD10-40/3-2.2J(220V/60Hz)	2.200	3.00	13.8	23.0	44.0	0 ~ 44	3×1.5-15	705×220×273	40.0	661

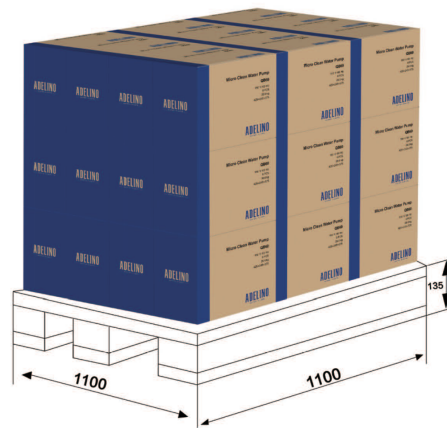

Components & Materials

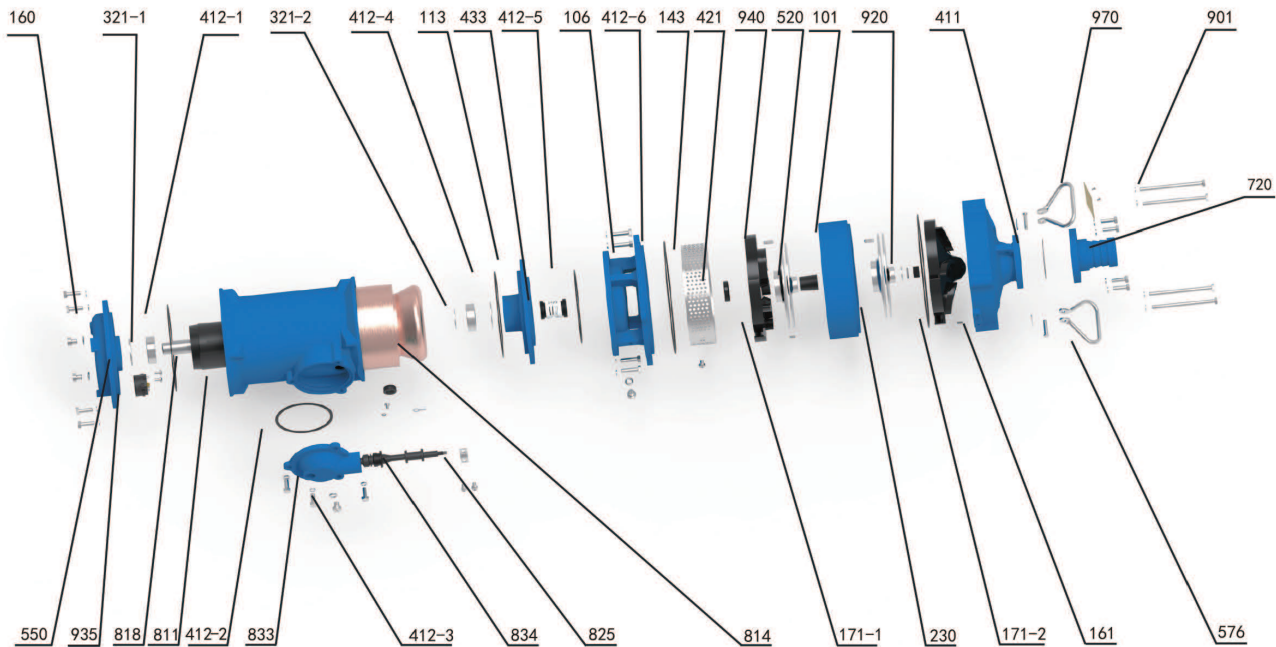

No.	Part name	No.	Part name	No.	Part name
101	Pump body	412-1	O-ring	811	Casing
106	Oil chamber	412-2	O-ring	814	Stator core with winding
113	Net cover	412-3	O-ring	818	Rotor
143	Oil chamber cover	412-4	O-ring	825	Cable pressing plate
160	Impeller	412-5	O-ring	833	Outlet box cover
161	Deep groove ball bearing	412-6	O-ring	834	Cable sheath
171-1	Deep groove ball bearing	421	Framework oil seal	901	Hexagon head bolt
171-2	O-ring	433	Mechanical seal	920	Hexagon nut - Style 1
230	O-ring	520	Shaft sleeve	935	Thermal protector
321-1	O-ring	550	Bearing washer	940	Ordinary flat key
321-2	Oil seal	576	Handle	970	Nameplate
411	Mechanical seal	720	Outlet joint		

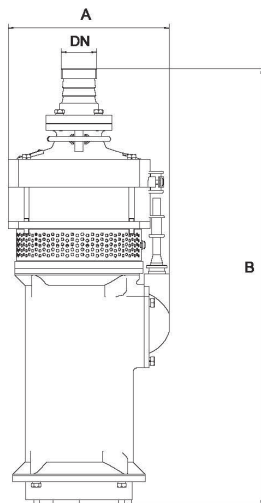

Dimensions & Weight

Model	Dim.(mm)			N.W. (kg)
	A	B	DN	
QD3-55/4-1.5J(220V/60Hz)	180	500	25	22.0
QD3-30/2-0.75(220V/60Hz)	180	575	25	30.0
QD10-26/2-1.5J(220V/60Hz)	190	530	51	28.0
QD6-35/2-1.5J(220V/60Hz)	190	515	38	28.0
QD10-40/3-2.2J(220V/60Hz)	190	660	51	36.0