

Performance Curve

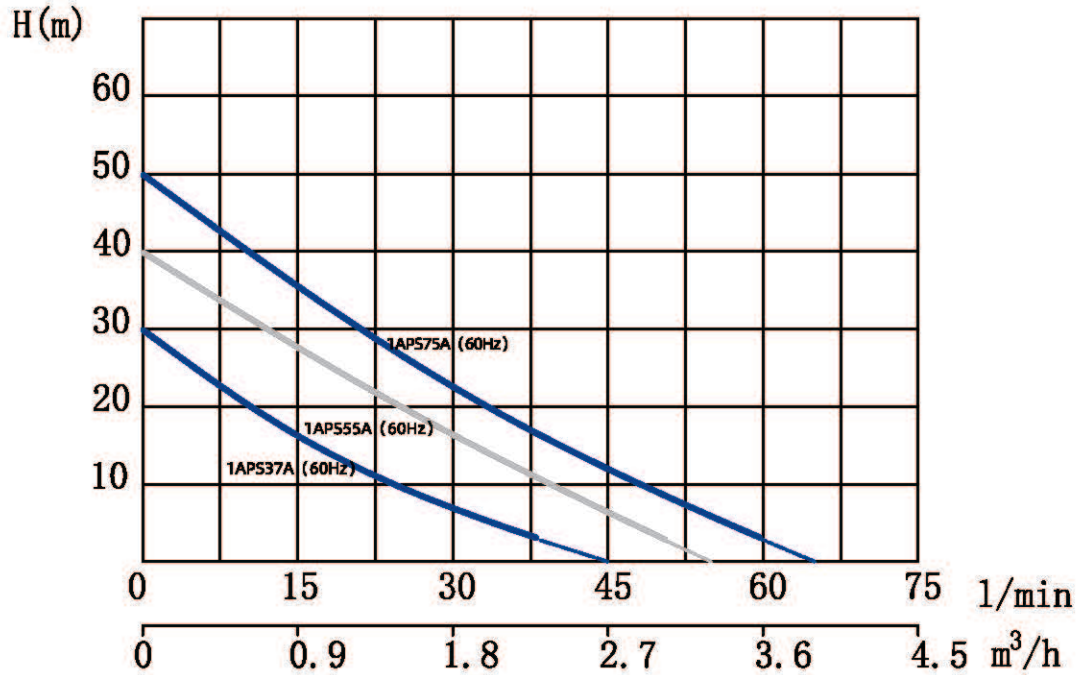

Model	Power		Max. Flow (m³/h)	Max. Head (m)	Head Range (m)	Max. Suction (m)
	kW	HP				
1APS37A (115V/60Hz)	0.37	0.5	2.7	30	0 ~ 27	8
1APS55A (115V/60Hz)	0.55	0.75	3.3	40	0 ~ 37	8
1APS75A (115V/60Hz)	0.75	1	3.9	50	0 ~ 47	8

Components & Materials

Model	1APS37A(115V/60Hz)	1APS37A(220V/60Hz)	1APS55A(115V/60Hz)	1APS75A(115V/60Hz)
Capacitor(µF)	AC20µF\250V	AC12µF\450V	AC40µF\250V	AC40µF\250V
End cap Bearing	6201-2RZ		6202-2RZ	
Connection Part Bearing	6201-2RZ		6202-2RZ	
Motor Shaft	Steel 45#+304			
Mechanical Seal	108-12/21 B:A (PC) Stator Ring φ26 A: Hot graphite, B: Alumina ceramic, P: Nitrile rubber, C: Stainless steel (06Cr19Ni10)			
Motor Case	Aluminum			
Coupling	Cast Iron			
Pump Body	Cast Iron			
Impeller	Brass			

Components & Materials

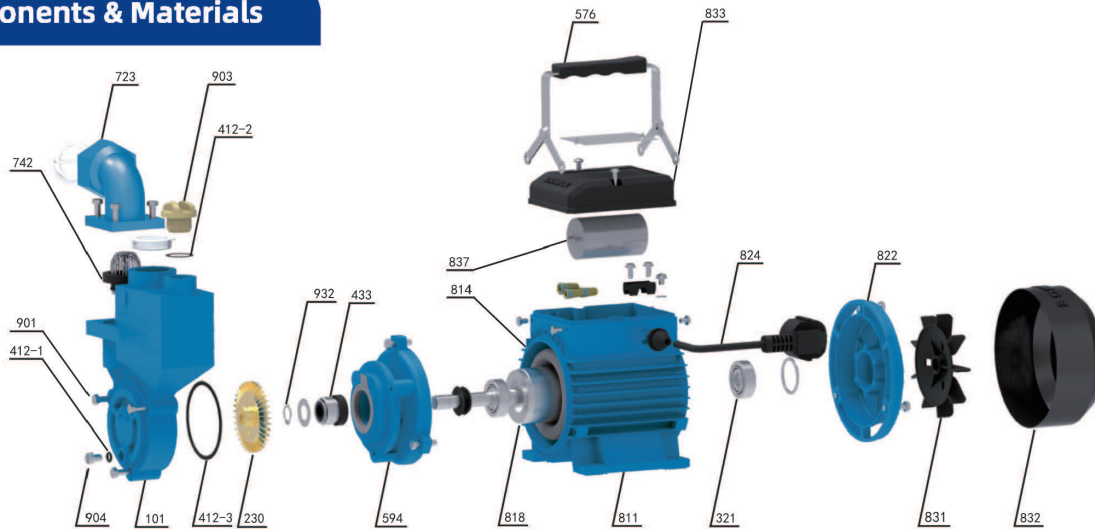

No.	Part name	No.	Part name	No.	Part name
101	Pump body	542	Cable pressure plate	832	Fan housing
106	Water inlet Festival	553	End cap	833	Junction box
143	Strainer	576	Handle	834	Cable
230	Impeller	594	Coupling	836	Cable sheath
321	Bearing	621	Wire holder	837	Capacitor
412	O-ring	813	Stator	900-1	Vent cock
433	Mechanical seal	821	Rotor	900-2	Vent cock
507	Washer	831	Fan		

Dimensions & Weight

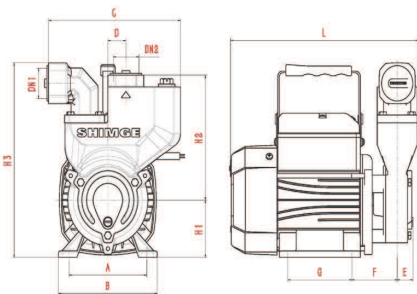

Model	DN1	DN2	Dim.(mm)										
	Inch		A	B	C	D	E	F	G	L	H1	H2	H3
1APS37A(60Hz)	1	1	100	123	164	22.5	19	56	80	235	63	137	216
1APS55A(60Hz)	1	1	112	136	164	22.5	22	54	88	253	72	148	233.5
1APS75A(60Hz)	1	1	112	136	164	22.5	22	54	88	253	72	148	233.5

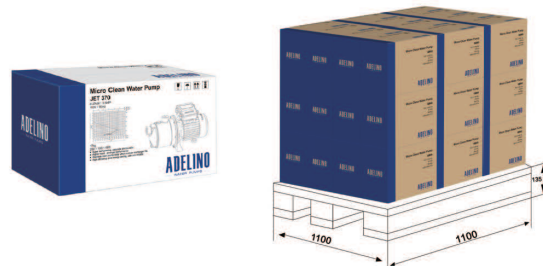

Packing Size & Weight

Model	Dim.(L×W×H) mm	G.W. (kg)	Dim. For Outer Packing(L×W×H)mm	G.W. (kg)	Packing Qty. (pcs)	20'Loading Qty. (pcs)
1APS37A(60Hz)	235×123×216	7.3	/	/	1	5225
1APS55A(60Hz)	253×136×235.5	9.7	/	/	1	3910
1APS75A(60Hz)	254×136×235.5	10.7	/	/	1	3910