

Performance Curve

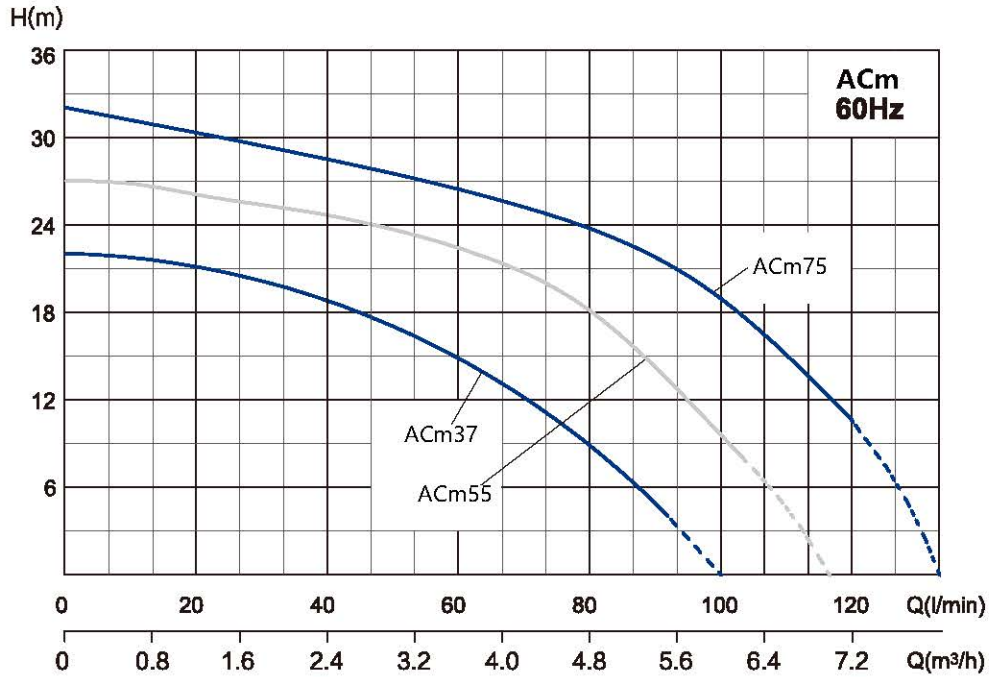

| Model | Power | | Max. Flow (m³/h) | Max. Head (m) | Head Range (m) | Max. Suction (m) |
|------------------|-------|------|------------------|---------------|----------------|------------------|
| | kW | HP | | | | |
| ACm37(115V/60Hz) | 0.37 | 0.5 | 6 | 22 | 8~22 | 7 |
| ACm37(220V/60Hz) | 0.37 | 0.5 | 6 | 22 | 8~22 | 7 |
| ACm55(115V/60Hz) | 0.55 | 0.75 | 7 | 26 | 11~26 | 7 |
| ACm55(220V/60Hz) | 0.55 | 0.75 | 7 | 26 | 11~26 | 7 |
| ACm75(115V/60Hz) | 0.75 | 1 | 8 | 32 | 14~32 | 7 |
| ACm75(220V/60Hz) | 0.75 | 1 | 8 | 32 | 14~32 | 7 |

NOTE: 0.3m short-term without plug

Components & Materials

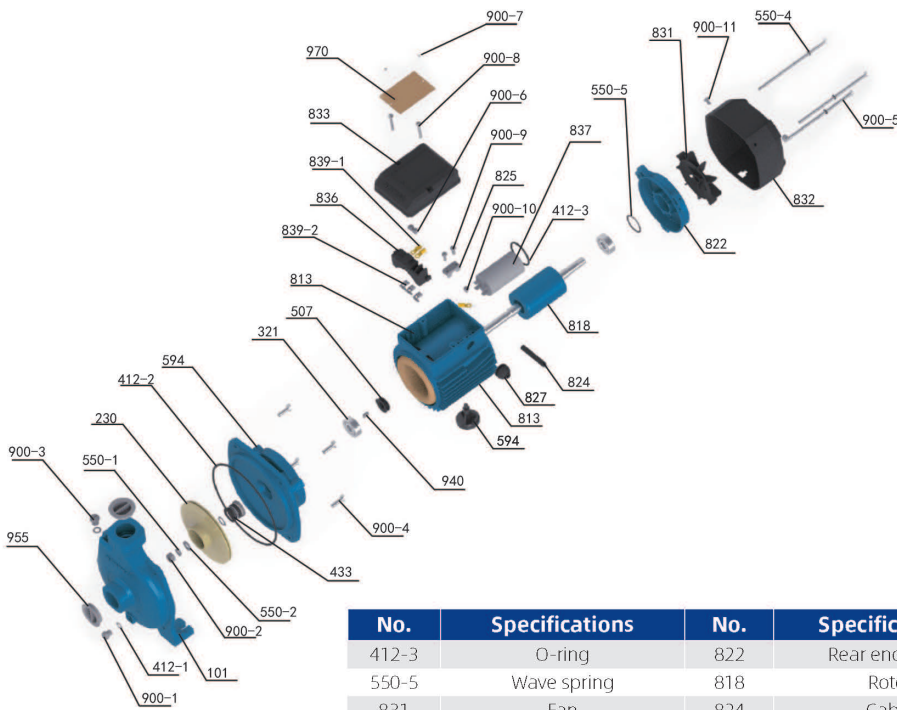

| No. | Specifications |
|--------|---------------------------------------|
| 955 | Dust cover |
| 900-3 | Vent cock |
| 550-1 | Spring washer |
| 220 | Impeller |
| 412-2 | O-ring |
| 594 | Connector |
| 321 | Deep groove ball bearing |
| 507 | Water retaining ring |
| 813 | Stator |
| 900-1 | Slotted cheese head screw |
| 839-2 | Insert spring 6.3 |
| 836 | Terminal block |
| 839-1 | Closed wiring terminal |
| 833 | Junction box |
| 970 | Nameplate |
| 900-7 | Rivet |
| 900-8 | Hexagon cross recessed pan head screw |
| 900-6 | Cross recessed flange screw |
| 900-9 | Hexagon cross recessed pan head screw |
| 825 | Cable pressing plate |
| 900-10 | Hexagon cross recessed pan head screw |
| 837 | Running capacitor |

| No. | Specifications | No. | Specifications | No. | Specifications |
|--------|-----------------------------|-----|----------------|-------|--------------------|
| 412-3 | O-ring | 822 | Rear end cover | 900-4 | Hexagon head bolt |
| 550-5 | Wave spring | 818 | Rotor | 433 | Mechanical seal |
| | Fan | 824 | Cable | 550-2 | Flat washer |
| 900-11 | Cross recessed flange screw | 827 | Cable sheath | 900-2 | Type I hexagon nut |
| 550-4 | Spring washer | 813 | Stator | 101 | Pump body |
| 900-5 | Hexagon bolt | 594 | Foot | 412-1 | O-ring |
| 832 | Fan cover | 940 | Flat key | | |

| Model | ACm75(115V/60Hz) | ACm75(220V/60Hz) | ACm55(220V/60Hz) | ACm55(115V/60Hz) | ACm37(220V/60Hz) | ACm37(115V/60Hz) |
|-------------------------|---|------------------|------------------|------------------|--------------------------------------|------------------|
| Capacitor(μF) | AC50μF\250V | AC25μF\450V | AC40μF\450V | AC15μF\250V | AC30μF\450V | AC12μF\250V |
| End cap Bearing | 6202-2RZ | 6202-2RZ | 6202-2RZ | 6202-2RZ | 6201-2RZ | 6201-2RZ |
| Connection Part Bearing | 6202-2RZ | 6202-2RZ | 6202-2RZ | 6202-2RZ | 6201-2RZ | 6201-2RZ |
| Motor Shaft | Steel 45#+304 | | | | | |
| Mechanical Seal | 108-14/25&S:A(PC) Stator Ring Φ28 | | | | 108-12/21&S:A(PC) Stator Ring Φ26 | |
| | A: Hot graphite, B: Alumina ceramic, P: Nitrile rubber, C: Stainless steel (06Cr19Ni10) | | | | | |
| Motor Case | Aluminum | | | | | |
| Coupling | CastIron | | | | | |
| Pump Body | CastIron | | | | | |
| Impeller | Brass/Plastics PPO/304 | | | | | |

Dimensions & Weight

| Model | DN1 | DN2 | Dim.(mm) | | | | | | | | |
|------------------|------|-----|----------|-------|----|----|-----|-------|----|----|-------|
| | Inch | | A | B | E | F | G | L | S | H1 | H2 |
| ACm37(115V/60Hz) | 1 | 1 | 120 | 148.5 | 44 | 32 | 110 | 266.5 | 9 | 86 | 123 |
| ACm37(220V/60Hz) | 1 | 1 | 120 | 148.5 | 44 | 32 | 110 | 266.5 | 9 | 86 | 123 |
| ACm55(115V/60Hz) | 1 | 1 | 120 | 148.5 | 44 | 32 | 119 | 289.5 | 9 | 86 | 123 |
| ACm55(220V/60Hz) | 1 | 1 | 120 | 148.5 | 44 | 32 | 119 | 289.5 | 9 | 86 | 123 |
| ACm75(115V/60Hz) | 1 | 1 | 131 | 159 | 49 | 37 | 112 | 294.5 | 10 | 92 | 131.5 |
| ACm75(220V/60Hz) | 1 | 1 | 131 | 159 | 49 | 37 | 112 | 294.5 | 10 | 92 | 131.5 |

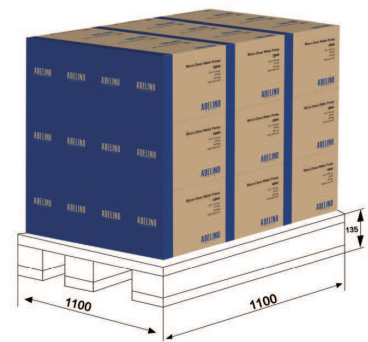
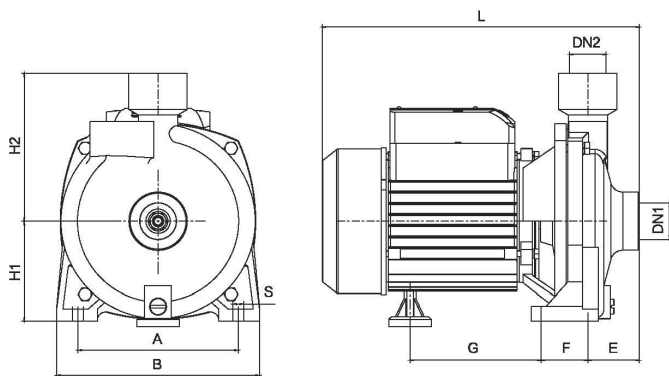

Packing Size & Weight

| Model | Dim.(L×W×H) mm | G.W. (kg) | 20' Loading Qty. (pcs) |
|------------------|----------------|-----------|------------------------|
| ACm37(115V/60Hz) | 300×195×255 | 7.7 | 1764 |
| ACm37(220V/60Hz) | 300×195×255 | 7.7 | 1764 |
| ACm55(115V/60Hz) | 325×195×255 | 10 | 1764 |
| ACm55(220V/60Hz) | 325×195×255 | 10 | 1764 |
| ACm75(115V/60Hz) | 330×200×275 | 12 | 1568 |
| ACm75(220V/60Hz) | 330×200×275 | 12 | 1568 |