

Performance Curve

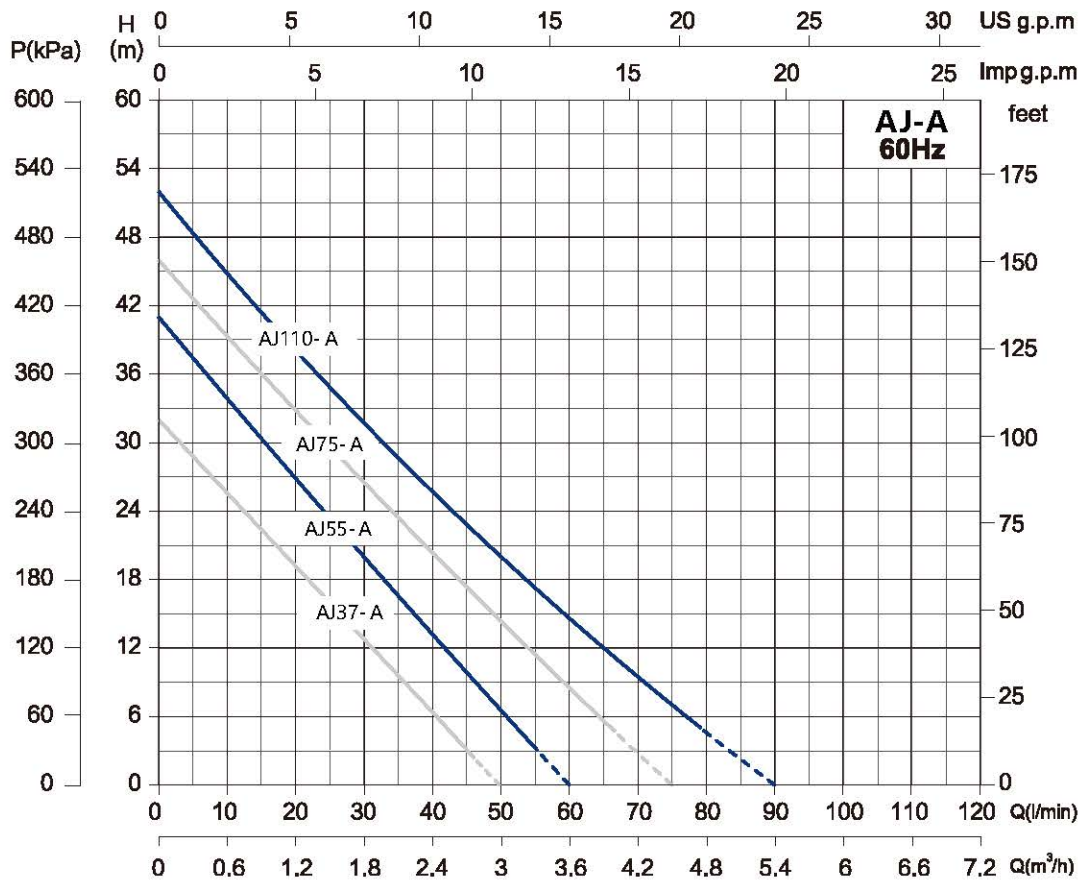

Model	Power		Max. Flow (m³/h)	Max. Head (m)	Head Range (m)	Max. Suction (m)
	kW	HP				
AJ37-A(120V-60Hz)	0.37	0.5	3	3.2	2.5-32	8
AJ37-A(220V-60Hz)						
AJ37-A(115V/230V-60Hz)						
AJ55-A(120V-60Hz)	0.55	0.75	3.6	41	3-41	9
AJ55-A(120V-60Hz)						
AJ55-A(115V/230V-60Hz)						
AJ75-A(120V-60Hz)	0.75	1	4.5	46	4.5-46	9
AJ75-A(220V-60Hz)						
AJ75-A(115V/230V-60Hz)						
AJ110-A(120V-60Hz)	1.1	1.5	5.4	52	5-52	9

NOTE: 0.3m short-term without plug

Components & Materials

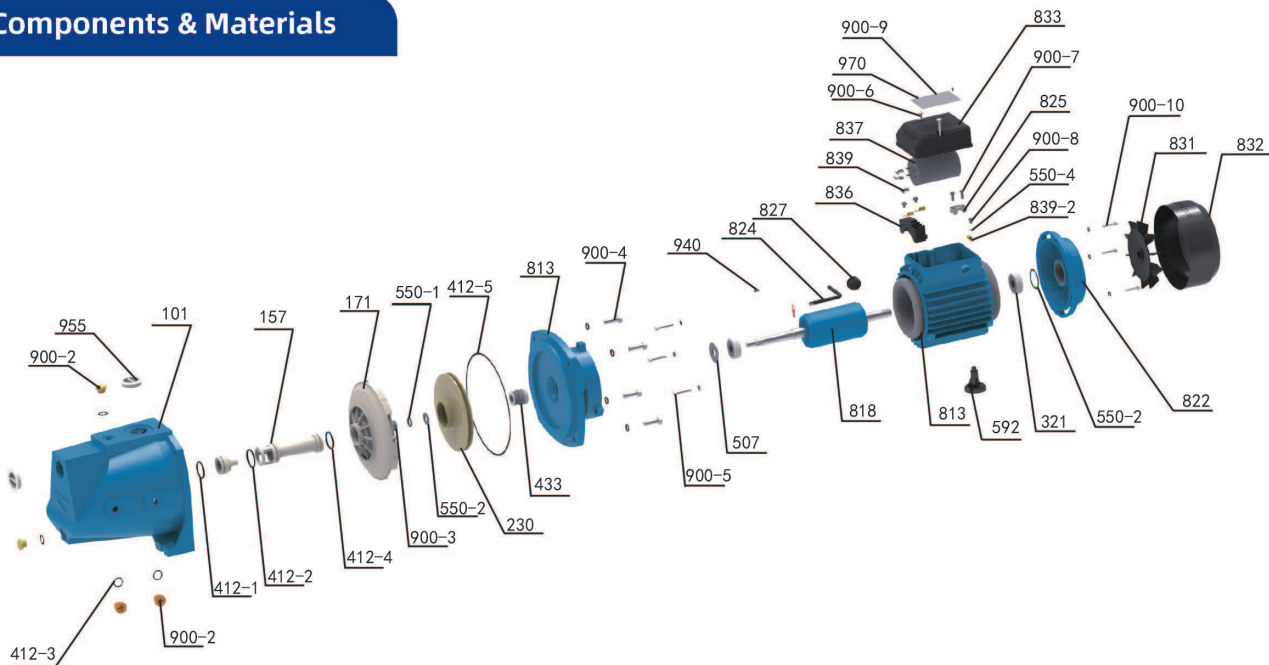

No.	Part name	No.	Part name	No.	Part name
900-1	Vent cock	970	Nameplate	818	Rotor
955	Dust cover	900-9	Rivet	507	Water retaining ring
101	Pump body	833	Junction box	900-5	Hexagon head bolt
157	Ejector	900-7	Cross recessed flange screw	433	O-ring
171	Guide vane	825	Cable pressing plate	230	Impeller
550-1	Spring washer	900-8	Cross recessed flange screw	550-2	Flat washer
412-5	O-ring	550-4	External teeth lock washer	900-3	Type I lock nut
813	Connector	839-2	Closed wiring terminal	412-4	O-ring
900-4	Hexagon head bolt	900-10	Hexagon head bolt	412-2	O-ring
940	Flat key	831	Fan	412-1	O-ring
824	Cable	832	Fan cover	900-2	Vent cock
827	Cable sheath	822	Rear end cover	412-3	O-ring
836	Terminal block	550-5	Wave spring		
839	6.3 spring	321	Deep groove ball bearing		
837	Running capacitor	592	Foot		
900-6	Cross recessed pan head screw	813	Stator		

Model	AJ37-A 120V-60Hz	AJ37-A 220V-60Hz	AJ37-A 115V/230V -60Hz	AJ55-A 120V-60Hz	AJ55-A 220V-60Hz	AJ55-A 115V/230V -60Hz	AJ75-A 120V-60Hz	AJ75-A 220V-60Hz	AJ75-A 115V/230V -60Hz	AJ110-A 120V-60Hz
Capacitor(μF)	16μF /250V	15μF /450V	20μF /250V	30μF /250V	18μF /450V	40μF /250V	40μF /250V	25μF /450V	60μF /250V	50μF /250V
End cap Bearing	6201-2RZ			6202-2RZ						
Connection Part Bearing	6201-2RZ			6202-2RZ						
Motor Shaft	Steel 45#+304									
Mechanical Seal	103-12/20.5 B:A (PC) Stator Ring Φ26				104-14/25 B:A (PC) Stator Ring Φ26					
	A: Hot graphite, B: Alumina ceramic, P: Nitrile rubber, C: Stainless steel (06Cr19Ni10)									
Motor Case	Aluminum									
Coupling	Cast Iron									
Pump Body	Cast Iron									
Impeller	Brass									

Dimensions & Weight

Model	DN1	DN2	Dim.(mm)										
	Inch		A	B	C	E	F	G	L	S	H1	H2	H3
AJ37-A(60Hz)	1	1	122	160	160	89	27	158	346.5	10	129.5	33.5	176.5
AJ55-A(60Hz)	1	1	142	187	187	144	11	196	430	10	154	38	207
AJ75-A(60Hz)	1	1	142	187	187	144	11	196	416	10	154	38	207
AJ110-A(60Hz)	1	1	142	187	187	144	11	196	430	10	154	38	207

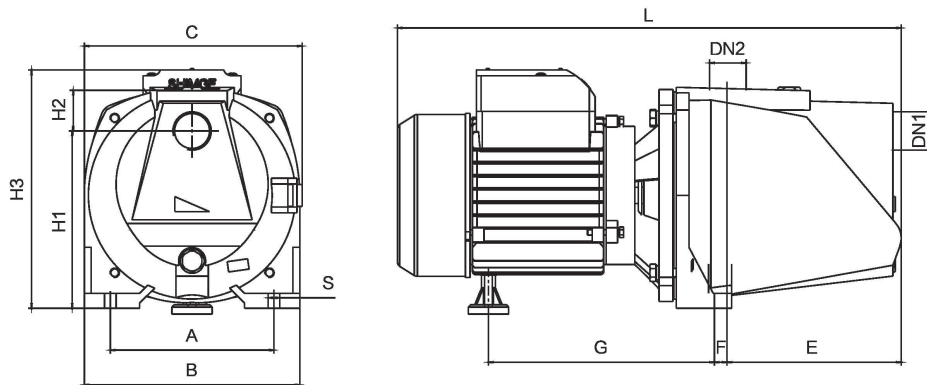

Packing Size & Weight

Model	Dim.(L×W×H) mm	G.W. (kg)	20' Loading Qty. (pcs)
AJ37-A(120V-60Hz)	390×190×230	8.5	1765
AJ37-A(220V-60Hz)	390×190×230	8.5	1765
AJ37-A(120V/220V-60Hz)	390×190×230	8.5	1765
AJ55-A(120V-60Hz)	475×195×230	15.5	1353
AJ55-A(120V-60Hz)	475×195×230	15.5	1353
AJ55-A(120V/220V-60Hz)	475×255×200	15.5	1242
AJ75-A(120V-60Hz)	475×195×230	15	1353
AJ75-A(220V-60Hz)	475×195×230	15	1353
AJ75-A(120V/220V-60Hz)	475×255×200	15	1242
AJ110-A(120V-60Hz)	475×195×230	17.5	1353

