

**Performance Curve**

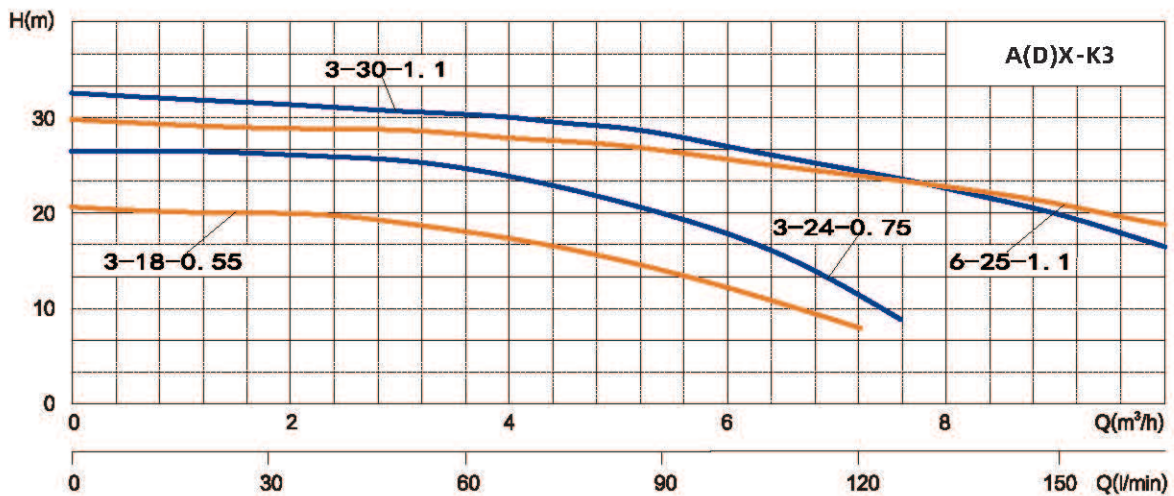

Performance Curve

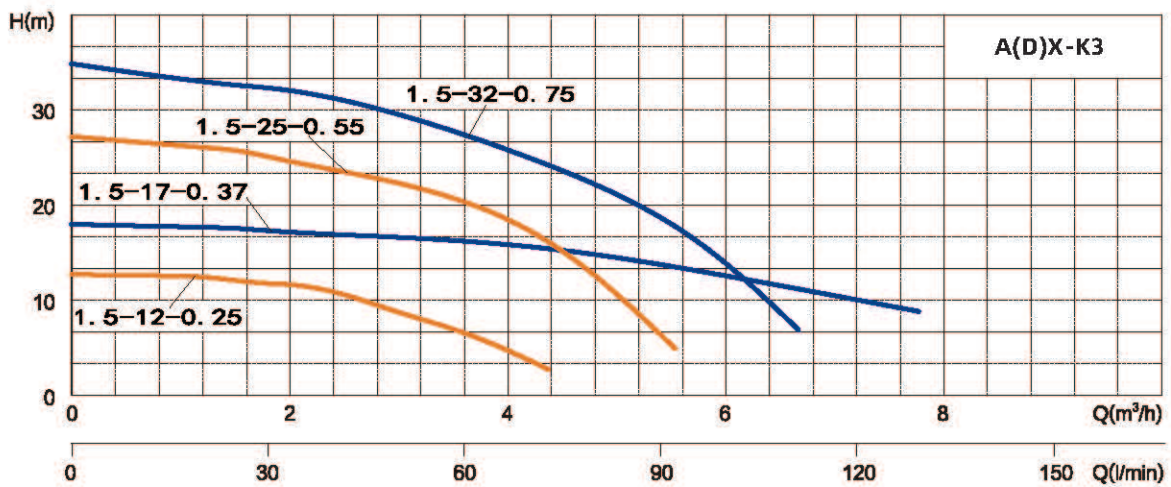
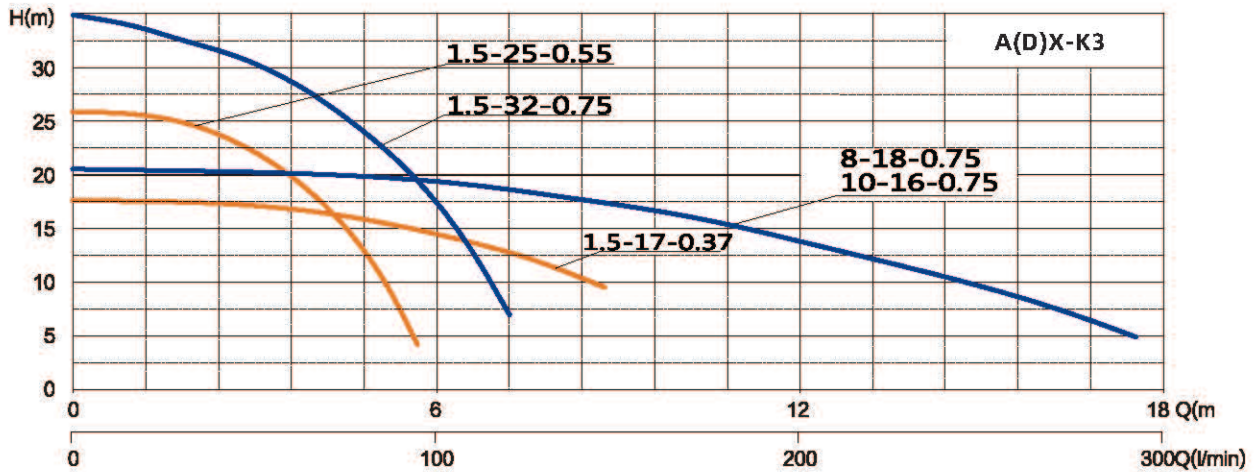
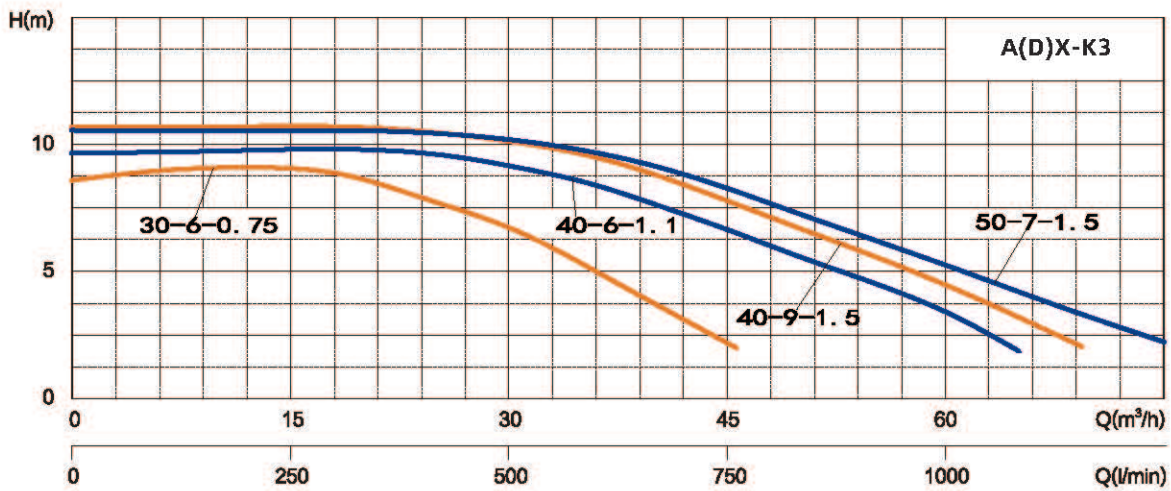
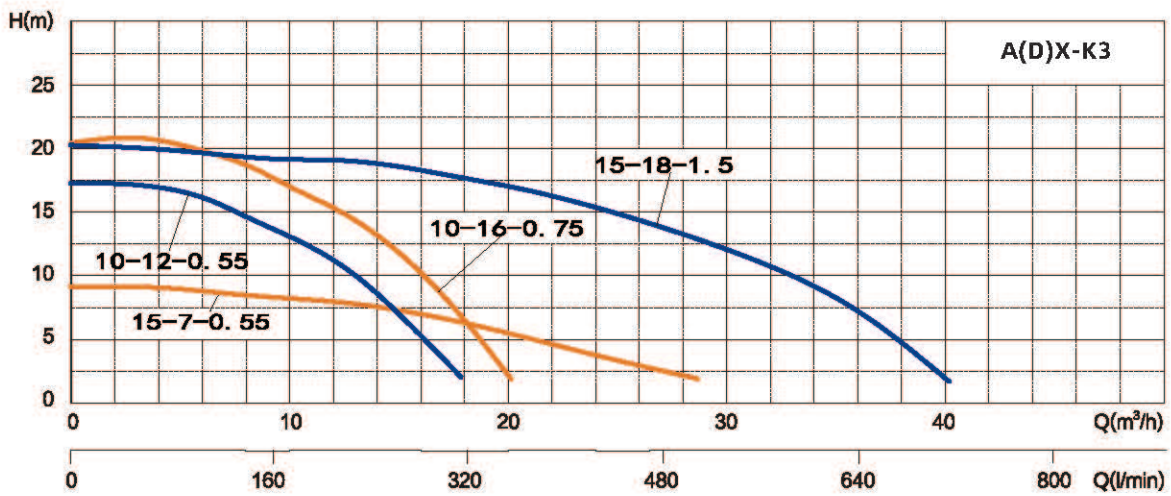
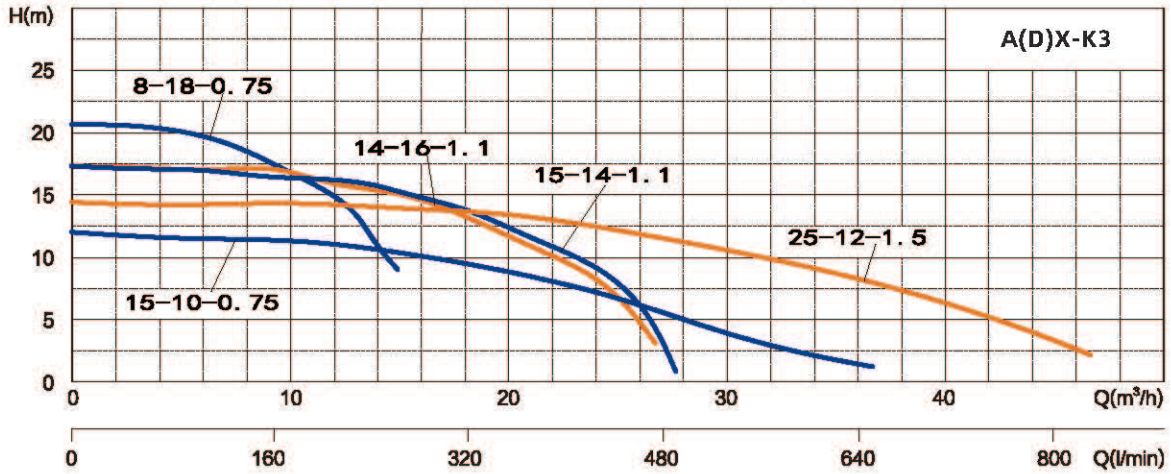

Model		Power		Rate Current (A)	Max. Flow (m <sup>3</sup> /h)	Max. Head (m)	Head Range (m)	Cable line (mm <sup>2</sup> -m)	Packing Dim. LxWxH(mm)	G.W (kg)	20'Loading Qty. (pcs)	DN
Single-Phase	Three-Phase	kW	HP									
ADX1.5-12-0.25K3	-	0.25	0.33	2.1	4.5	13	5 ~ 13	3x0.75-8	360x180x200	6	2160	G3/4
ADX1.5-17-0.37K3	-	0.37	0.5	2.9	9.5	18	7 ~ 18	3*0.75-8	380x160x200	8	2499	G3/4
ADX1.5-25-0.55K3	-	0.55	0.75	4.1	5.5	25	15 ~ 26	3*0.75-8	395x180x220	10.5	1776	G3/4
ADX3-18-0.55K3	-	0.55	0.75	4.1	8	21	5 ~ 21	3x0.75-8	410x210x220	11	1478	G1
ADX10-12-0.55K3	-	0.55	0.75	4.1	18	17	5 ~ 16	3x0.75-8	410x210x220	11.5	1478	G1½
ADX15-7-0.55K3	-	0.55	0.75	4.1	25	9	3 ~ 9	3x0.75-8	410x210x220	11.5	1478	G1½
ADX1.5-32-0.75K3	-	0.75	1	5.2	6.5	34	12 ~ 33	3*0.75-8	420x210x230	12.5	1606	G3/4
ADX3-24-0.75K3	-	0.75	1	5.2	7.5	26	14 ~ 26	3x0.75-8	410x195x220	12.5	1592	G1
ADX8-18-0.75K3	-	0.75	1	5.2	16	20	15 ~ 19	3*0.75-8	420x195x230	13	1614	G1½
ADX10-16-0.75K3	-	0.75	1	5.2	19	20	10 ~ 19	3*0.75-8	420x195x230	13	1614	G1½
ADX30-6-0.75K3	-	0.75	1	5.2	47	8	2 ~ 8	3x0.75-8	450x280x210	16.5	1058	G1½
ADX15-10-0.75K3	-	0.75	1	5.2	33	11	3 ~ 11	3x0.75-8	430x280x210	13.5	1107	G2
ADX3-30-1.1K3	-	1.1	1.5	7.3	10	33	18 ~ 32	3x1-8	455x285x225	15.5	960	G3/4
ADX6-25-1.1K3	-	1.1	1.5	7.3	12	30	8 ~ 29	3x1-8	455x285x225	15.5	960	G1½
ADX14-16-1.1K3	-	1.1	1.5	7.3	29	17	9 ~ 17	3x1-8	470x285x225	17	929	G1½
ADX15-14-1.1K3	-	1.1	1.5	7.3	30	17	9 ~ 17	3x1-8	470x285x225	17	929	G2
ADX40-7-1.1K3	-	1.1	1.5	7.3	60	9	3 ~ 9	3x1-8	505x310x215	18.5	832	G2½
ADX15-18-1.5K3	-	1.5	2	9.5	38	20	8 ~ 19	3x1.5-8	505x280x215	20	921	G2
ADX40-9-1.5K3	-	1.5	2	9.5	66	11	2 ~ 11	3x1.5-8	550x325x230	23	681	G2½
ADX50-7-1.5K3 (with outlet of 4 inches)	-	1.5	2	9.5	77	11	2 ~ 11	3x1.5-8	550x325x230	23	681	G3½,G2½
-	AX10-12-0.55K3	0.55	0.75	1.6	18	17	5 ~ 16	4x0.75-8	410x210x220	11.5	1478	G1½
-	AX1.5-32-0.75K3	0.75	1	2	6.5	34	12 ~ 33	4x0.75-8	420x210x230	11.5	1380	G3/4
-	AX3-24-0.75K3	0.75	1	2	7.5	26	14 ~ 26	4x0.75-8	410x195x220	11	1592	G1
-	AX8-18-0.75K3	0.75	1	2	16	20	15 ~ 19	4x0.75-8	420x195x230	12	1486	G1½
-	AX10-16-0.75K3	0.75	1	2	19	20	10 ~ 19	4x0.75-8	420x195x230	12	1486	G1½
-	AX30-6-0.75K3	0.75	1	2	47	8	2 ~ 8	4x0.75-8	450x280x210	17	1058	G2½
-	AX3-30-1.1K3	1.1	1.5	2.7	10	33	18 ~ 32	4x0.75-8	455x285x225	14	960	G3/4
-	AX6-25-1.1K3	1.1	1.5	2.7	12	30	8 ~ 29	4x0.75-8	455x285x225	14	960	G1½
-	AX14-16-1.1K3	1.1	1.5	2.7	29	17	9 ~ 17	4x0.75-8	470x285x225	15.5	929	G1½
-	AX15-14-1.1K3	1.1	1.5	2.7	30	17	9 ~ 17	4x0.75-8	470x285x225	15.5	929	G2
-	AX40-7-1.1K3	1.1	1.5	2.7	60	9	3 ~ 9	4x0.75-8	505x310x215	18.5	832	G2½
-	AX15-18-1.5K3	1.5	2	3.6	40	20	8 ~ 19	4x0.75-8	505x280x215	17.5	921	G2
-	AX40-9-1.5K3	1.5	2	3.6	66	11	2 ~ 11	4x0.75-8	550x325x230	21	681	G2½
-	AX50-7-1.5K3 (with outlet of 4 inches)	1.5	2	3.6	77	11	2 ~ 11	4x0.75-8	550x325x230	21	681	G3½,G2½
-	AX25-12-1.5K3	1.5	2	3.6	45	16	5 ~ 15	4x0.75-8	490x285x225	17.5	891	G2

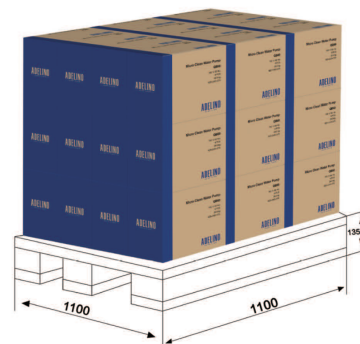

## Components & Materials

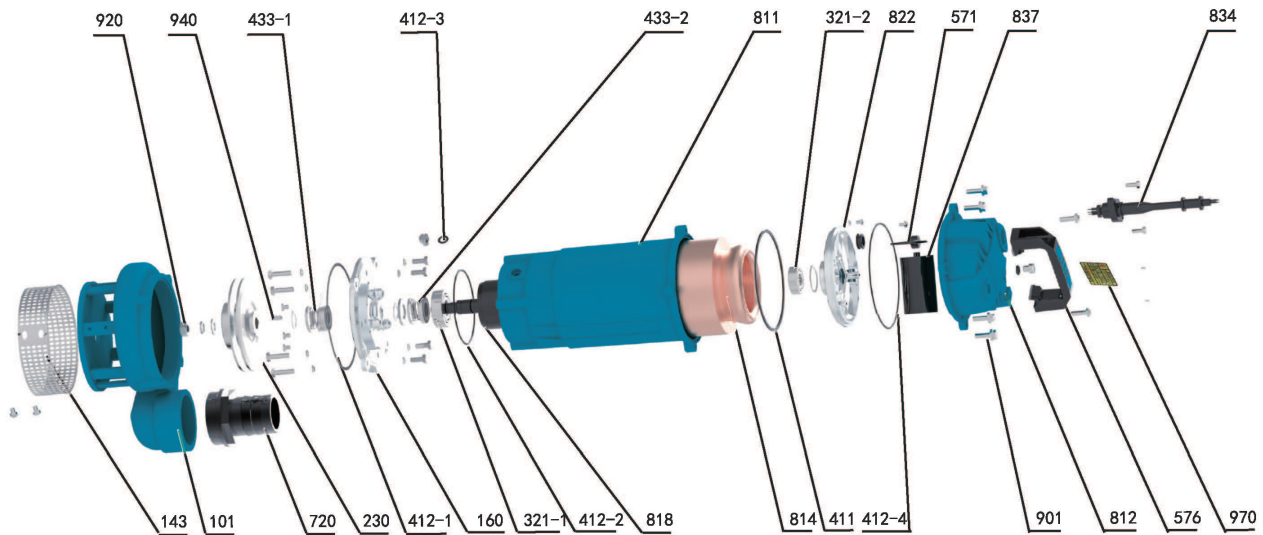

No.	Part name	No.	Part name
101	Pump body	576	Handle
143	Net cover	720	Outlet joint
160	Oil chamber cover	811	Casing
230	Impeller	812	Head cover
321-1	Deep groove ball bearing	814	Stator core with winding
321-2	Deep groove ball bearing	818	Rotor
411	Rubber washer	822	Upper bearing block
412-1	O-ring	834	Cable sheath
412-2	O-ring	837	Capacitor
412-3	O-ring	901	Hexagon flange bolt
412-4	O-ring	920	Hexagon nut - Style 1
433-1	Mechanical seal	940	Ordinary flat key
433-2	Mechanical seal	970	Nameplate
571	Capacitor fixing ring		

## Dimensions & Weight

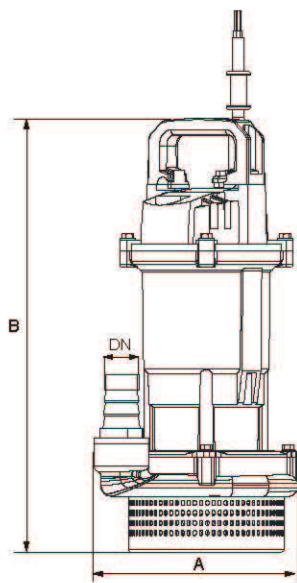

Model		Dim.(mm)			N. w. (kg)
Single-Phase	Three-Phase	A	B	DN	
ADX1.5-12-0.25K3	-	175	325	1"	5.5
ADX1.5-17-0.37K3	-	190	355	1"	7.5
ADX1.5-25-0.55K3	-	205	370	1"	10
ADX3-18-0.55K3	-	210	370	1.25"	10.5
ADX10-12-0.55K3	-	230	370	1.5"	11
ADX15-7-0.55K3	-	235	370	2"	11
ADX1.5-32-0.75K3	-	235	390	1"	12
ADX3-24-0.75K3	-	215	385	1.25"	12
ADX8-18-0.75K3	-	230	390	1.5"	12.5
ADX10-16-0.75K3	-	230	390	2"	12.5
ADX15-10-0.75K3	-	245	405	2.5"	13
ADX30-6-0.75K3	-	265	415	3"	15.5
ADX3-30-1.1K3	-	270	430	1"	14.5
ADX6-25-1.1K3	-	235	430	2"	14.5
ADX14-16-1.1K3	-	240	430	2"	16
ADX15-14-1.1K3	-	240	430	2.5"	16
ADX40-7-1.1K3	-	300	470	3"	17.5
ADX15-18-1.5K3	-	240	470	2.5"	19
ADX40-9-1.5K3	-	265	500	3 3/4"	21
ADX50-7-1.5K3	-	300	500	4"	21
-	AX10-12-0.55K3	230	370	1.5"	10
-	AX1.5-32-0.75K3	235	390	1"	11
-	AX3-24-0.75K3	215	385	1.25"	10.5
-	AX8-18-0.75K3	230	390	1.5"	12.5
-	AX10-16-0.75K3	230	390	2"	12.5
-	AX30-6-0.75K3	265	415	3"	14
-	AX3-30-1.1K3	270	430	1"	13
-	AX6-25-1.1K3	235	430	2"	13
-	AX14-16-1.1K3	240	430	2"	16
-	AX15-14-1.1K3	240	430	2.5"	16
-	AX40-7-1.1K3	300	470	3"	17
-	AX15-18-1.5K3	240	450	2.5"	16.5
-	AX25-12-1.5K3	240	465	2.5"	16.5
-	AX40-9-1.5K3	265	485	3"	19
-	AX50-7-1.5K3	300	485	3 3/4"	19