

Performance Curve

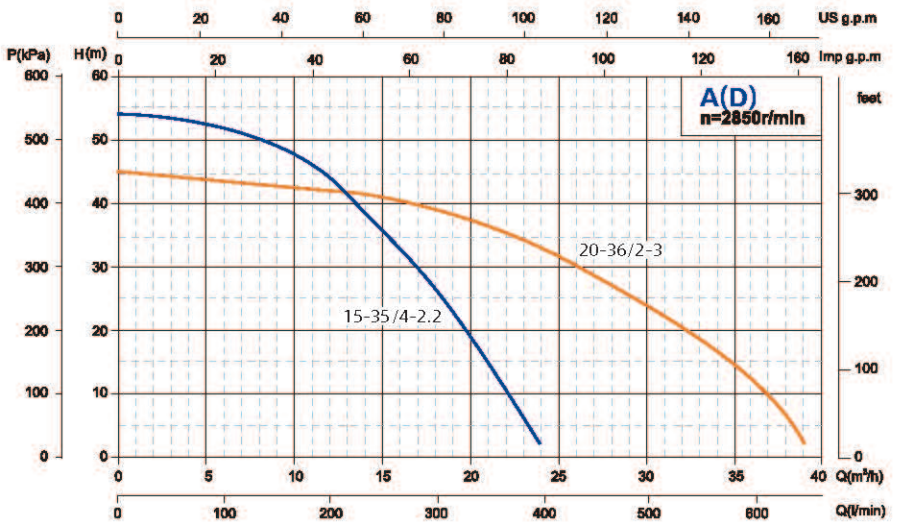

Model		Power		Rate Current (A)	Max. Flow (m ³ /h)	Max. Head (m)	Head Range (m)	Cable line (m)	Dim.mm (LxBxH)	G.W. (kg)	20' Loading Qty. (pcs)
Single-Phase	Three-Phase	kW	HP								
AD3-34/2-0.75	-	0.75	1	5.2	5	38	38~0	3*0.75-15	495x220x235	24	1170
AD3-50/3-1.1J	-	1.1	1.5	7.3	5	55	55~0	3*1-15	535x220x235	26	900
AD6-34/2-1.1J	-	1.1	1.5	7.3	14	37	37~20	3*1-15	535x220x235	27	900
AD6-34/2-1.1P	-	1.1	1.5	7.3	14	37	37~20	3*1-15	535x220x235	24	900
AD3-60/4-1.5J	-	1.5	2	9.5	5	66	66~0	3*1-15	610x220x235	31	810
AD6-35/2-1.5J	-	1.5	2	9.5	15	40	40~20	3*1-15	580x220x235	30	900
AD10-32/3-1.5J	-	1.5	2	9.5	20	39	39~20	3*1-15	610x220x235	32	810
AD10-32/3-1.5P	-	1.5	2	9.5	20	39	39~20	3*1-15	610x220x235	29	810
AD15-20/2-1.5J	-	1.5	2	9.5	23	29	29~0	3*1-15	570x220x215	30	1000
AD3-85/5-1.8J	-	1.8	2.5	11.4	8	88	88~50	3*2-15	770x220x273	41	640
AD12-36/3-1.8J	-	1.8	2.5	11.4	21	43	40~10	3*2-15	670x205x275	38	640
AD3-98/6-2.2J	-	2.2	3	13.8	8	105	105~55	3*2-15	770x220x273	45	560
AD10-40/3-2.2J	-	2.2	3	13.8	23	44	43~0	3*2-15	705x220x273	40	640
AD15-35/4-2.2J	-	2.2	3	13.8	23	50	50~5	3*2-15	780x220x273	43	598
-	A3-34/2-0.75	0.75	1	2	5	38	38~0	4*0.75-15	495x220x235	22	990
-	A3-34/2-0.75P	0.75	1	2	5	38	38~0	4*0.75-15	495x220x235	23	990
-	A3-50/3-1.1J	1.1	1.5	2.7	5	55	55~0	4*0.75-15	525x220x215	25	900
-	A6-34/2-1.1J	1.1	1.5	2.7	14	37	37~20	4*0.75-15	525x220x215	24	900
-	A6-34/2-1.1P	1.1	1.5	2.7	14	37	37~20	4*0.75-15	525x220x215	23	900
-	A3-60/4-1.5J	1.5	2	3.6	5	66	66~0	4*1-15	570x220x215	29	810
-	A6-35/2-1.5J	1.5	2	3.6	15	40	40~20	4*1-15	525x220x215	27	900
-	A10-32/3-1.5J	1.5	2	3.6	20	39	36~20	4*1-15	580x220x235	30	810
-	A10-32/3-1.5P	1.5	2	3.6	20	39	36~20	4*1-15	610x220x235	26	810
-	A15-20/2-1.5J	1.5	2	3.6	23	29	29~0	4*1-15	525x220x215	26	1000
-	A3-85/5-1.8J	1.8	2.5	4.3	8	88	88~50	4*1-15	740x220x273	37	640
-	A12-36/3-1.8J	1.8	2.5	4.3	21	43	40~10	4*1-15	640x205x278	38	720
-	A12-36/3-1.8P	1.8	2.5	4.3	21	43	40~10	4*1-15	640x205x278	36	720
-	A3-98/6-2.2J	2.2	3	5.1	9.4	106	105~55	4*1-15	740x220x273	40	640
-	A10-40/3-2.2J	2.2	3	5.1	23	44	43~0	4*1-15	610x215x278	36	720
-	A15-35/4-2.2J	2.2	3	5.1	23	50	48~5	4*1-15	690x220x273	37	683
-	A3-116/7-3J	3	4	6.7	9	129	125~60	3*1.5+1*1-15	770x220x273	46	560
-	A20-36/2-3J	3	4	6.7	40	46	40-30	3*1.5+1*1-15	690x290x305	49.5	459

Centrifugal pumps are not recommended to be used less than the lift range.
 Note: 0.75~1.5kw use honeycomb box. More than 1.8kw woode
 A(D)-P seawater type for coastal customers

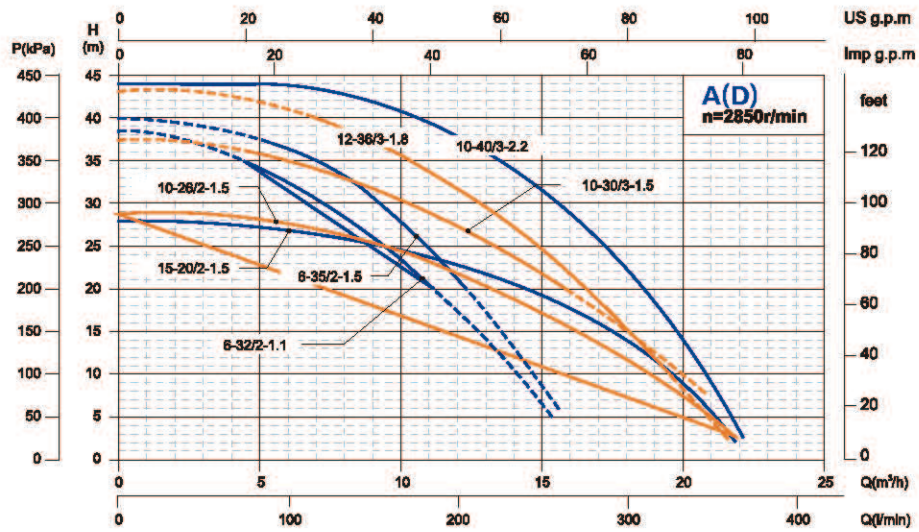
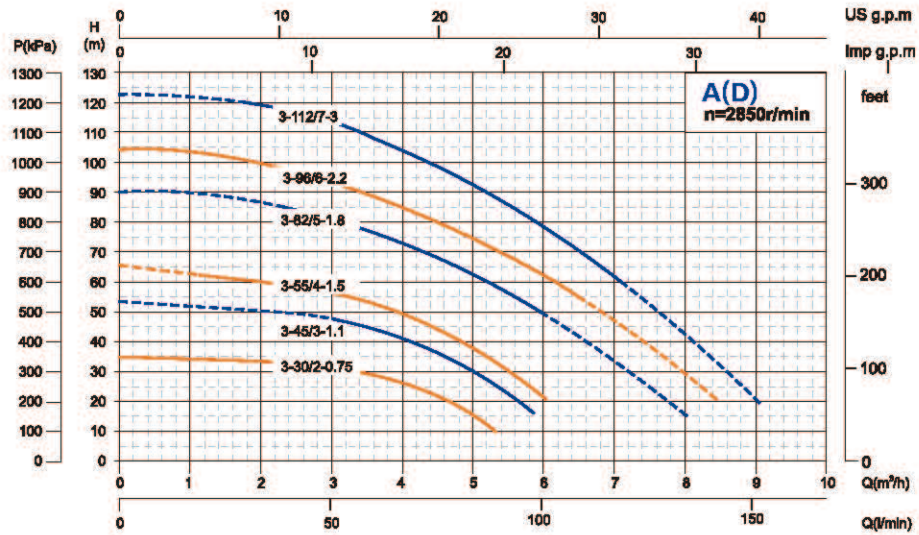
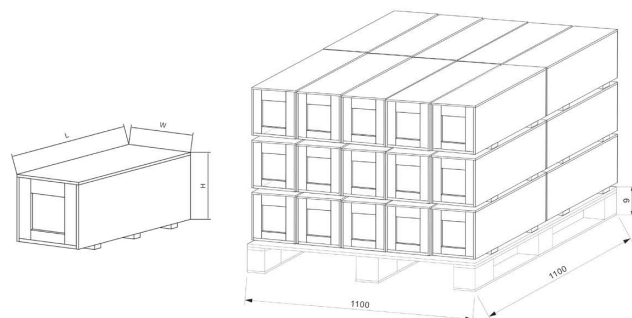

Components & Materials

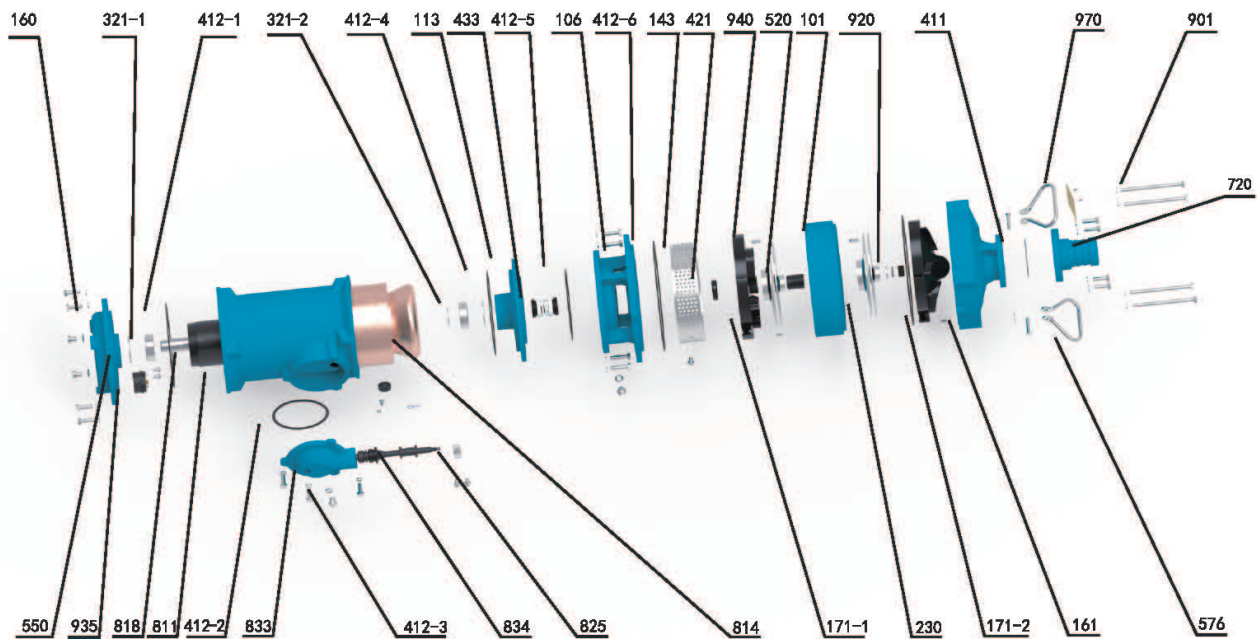

No.	Part name	No.	Part name	No.	Part name
101	Pump body	412-1	O-ring	811	Casing
106	Oil chamber	412-2	O-ring	814	Stator core with winding
113	Net cover	412-3	O-ring	818	Rotor
143	Oil chamber cover	412-4	O-ring	825	Cable pressing plate
160	Impeller	412-5	O-ring	833	Outlet box cover
161	Deep groove ball bearing	412-6	O-ring	834	Cable sheath
171-1	Deep groove ball bearing	421	Framework oil seal	901	Hexagon head bolt
171-2	O-ring	433	Mechanical seal	920	Hexagon nut - Style 1
230	O-ring	520	Shaft sleeve	935	Thermal protector
321-1	O-ring	550	Bearing washer	940	Ordinary flat key
321-2	Oil seal	576	Handle	970	Nameplate
411	Mechanical seal	720	Outlet joint		

Dimensions & Weight

Model		Dim.(mm)			N.W. (kg)
Single-Phase	Three-Phase	ø	B	DN	
AD3-34/2-0.75	-	192	488	1"	22
AD3-50/3-1.1J	-	192	520	1"	25
AD6-34/2-1.1J	-	200	475	1.5"	25
AD6-34/2-1.1P	-	200	475	1.5"	22
AD3-60/4-1.5J	-	192	595	1"	30
AD6-35/2-1.5J	-	200	520	1.5"	28
AD10-32/3-1.5J	-	200	555	2"	30
AD10-32/3-1.5P	-	200	555	2"	27
AD15-20/2-1.5J	-	200	515	2.5"	29
AD3-85/5-1.8J	-	195	667	1"	37
AD12-36/3-1.8J	-	200	590	2"	34
AD3-98/6-2.2J	-	195	735	1"	41
AD10-40/3-2.2J	-	200	630	2"	36
AD15-35/4-2.2J	-	190	685	2.5"	39
-	A3-34/2-0.75	192	470	1"	20
-	A3-34/2-0.75P	192	485	1"	22
-	A3-50/3-1.1J	192	512	1"	24
-	A6-34/2-1.1J	200	470	1.5"	25.5
-	A6-34/2-1.1P	200	470	1.5"	21
-	A3-60/4-1.5J	192	545	1"	27
-	A6-35/2-1.5J	200	470	1.5"	26
-	A10-32/3-1.5J	199	505	2"	28
-	A10-32/3-1.5P	199	505	2"	24
-	A15-20/2-1.5J	200	465	2.5"	25
-	A3-85/5-1.8J	195	630	1"	33
-	A12-36/3-1.8J	200	550	2"	32
-	A12-36/3-1.8P	200	550	2"	28
-	A3-98/6-2.2J	195	660	1"	36
-	A10-40/3-2.2J	200	550	2"	32
-	A15-35/4-2.2J	187	685	2.5"	34
-	A3-116/7-3J	195	731	1"	42
-	A20-36/2-3J	228	618	2.5"	43.5

