

Performance Curve

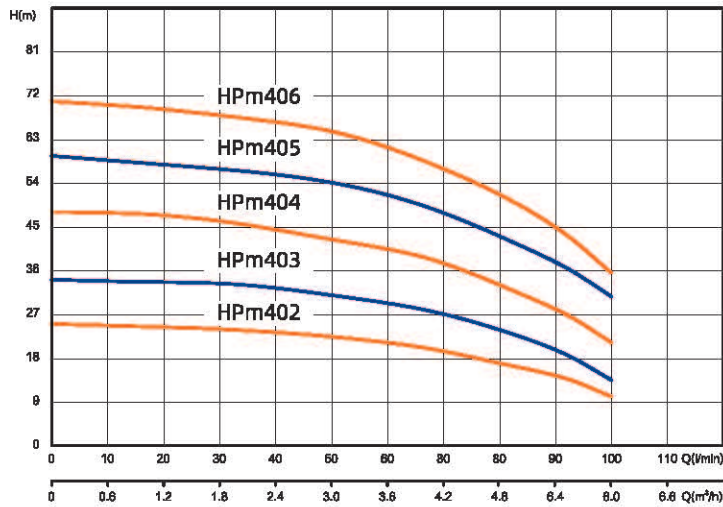

Model	Power		Max. Flow (m³/h)	Max. Head (m)	Head Range (m)	Max. Suction (m)
	kW	HP				
HPm202	0.31	0.4	5.4	22	22~4	7
HPm203	0.37	0.5	5.4	32	32~4.5	7
HPm204	0.55	0.75	5.4	42	42~5	7
HPm402	0.55	0.75	6.5	23	23~10	8
HPm403	0.75	1.02	6.5	34	34~12	8
HPm404	0.90	1.22	6.5	45	45~15	8
HPm405	1.10	1.50	6.5	57	57~20	8
HPm406	1.50	2.04	6.5	68	68~30	8

Components & Materials

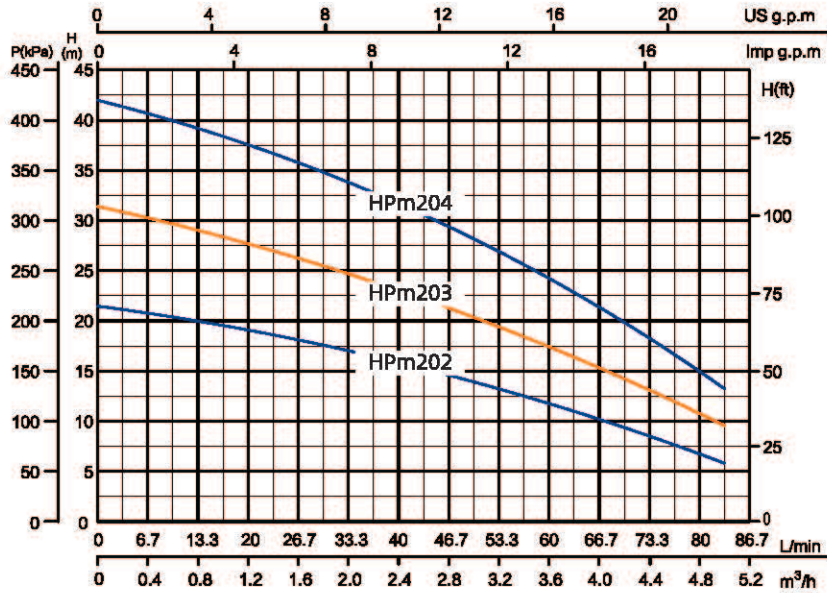
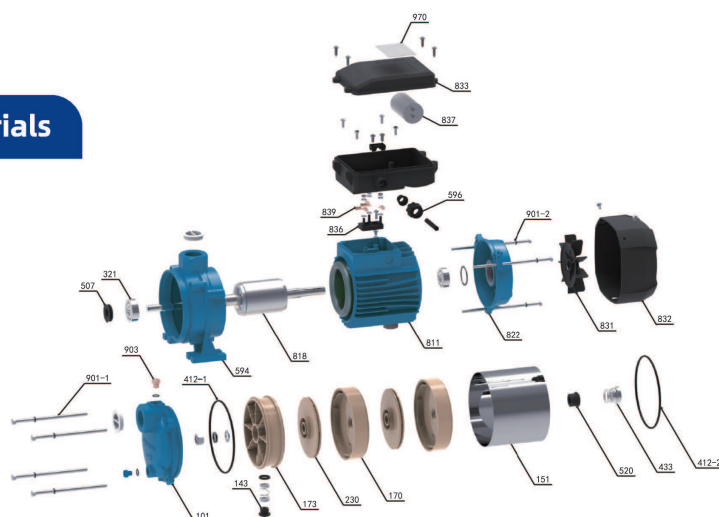

No.	Part name	No.	Part name	No.	Part name
106	Inlet pump casing	550-2	Flat washer	900-1	Cross recessed hexagon bolt
107	Connector	550-3	Wave spring	900-2	Cross recessed pan head self-tapping screw
151	Pump cylinder	550-4	Flat washer	900-3	Hexagon nut - Style 1
171	Guide vane	550-5	Spring washer	900-4	Cross recessed small pan head screw
173	Guide vane cover plate	550-6	Spring washer	900-5	Cross recessed flange screw
230	Impeller	813	Stator	900-6	Cross recessed pan head self-tapping screw
321	Deep groove ball bearing	818	Rotor	900-7	Hexagon nut - Style 1
410-1	Rubber gasket	824	Cable	900-8	Vent cock
410-2	Rubber washer	825	Cable pressing plate	900-9	Hexagon head bolt
410-3	Rubber gasket	827	Cable sheath	900-10	Slotted cheese head screw
412	O-ring	831	Fan	900-11	Cross recessed flange screw
433	Mechanical seal	832	Fan cover	955	Dust cover
507	Water retaining ring	833	Junction box assembly	970	Nameplate
520-1	Shaft sleeve	836	Wiring board	972	Earthing mark
520-2	Bushing	837	Capacitor		
550-1	External teeth lock washer	839	Wiring terminal		

Model	HPm202	HPm203	HPm204
Capacitor(μF)	15μF/450V	15μF/450V	25μF/450V
End cap Bearing	6201-2RZ	6201-2RZ	6201-2RZ
Connection Part Bearing	6201-2RZ	6201-2RZ	6201-2RZ
Motor Shaft	2Cr13		
Mechanical Seal	108-12/21 B:A(PC) A:Graphite,K:Impregnated resin sintered graphite,W:;Tungsten carbide,B:Alumina ceramics,F:Fluorine rubber,P:NBR,E:Ethylene propylene rubber, T:Plating Manganese steel with chromium,C:Stainless steel(06Cr19Ni10),H:brass		
Chassis	Aluminium		
Connecting fittings	Cast Iron		
Water shell	Cast Iron		
Pump cylinder	304		
Guide vane	PPO+GF30		
The rotor	PPO+GF30		

Model	HPm402	HPm403	HPm404	HPm405	HPm406
Capacitor(μF)	15μF/450V	20μF/450V	20μF/450V	AC30μF/450V	AC40μF/450V / AC45μF/450V
End cap Bearing	6203-2RZ			6204-2RZ	6204-2RZ
Connection Part Bearing	6202-2RZ				
Motor Shaft	#420			#45+#304	
Mechanical Seal	108-16/25 & S:A(PC)Static ring 30				
chassis	YL102				
Back cover	YL102				
Coupling	HT200				
Pump barrel	#304				
Impeller	PPO				

Dimensions & Weight

Model	DN1	DN2	Dim.(mm)									N.W. (kg)
	Inch		A	B	C	D	E	F	G	H	I	
HPm202	1	1	161	210.5	212	110	74	170	140	102	150.5	7.5
HPm203	1	1	187	236.5	212	110	74	170	140	102	150.5	8.5
HPm204	1	1	213	262.5	212	110	74	170	140	102	150.5	10.5

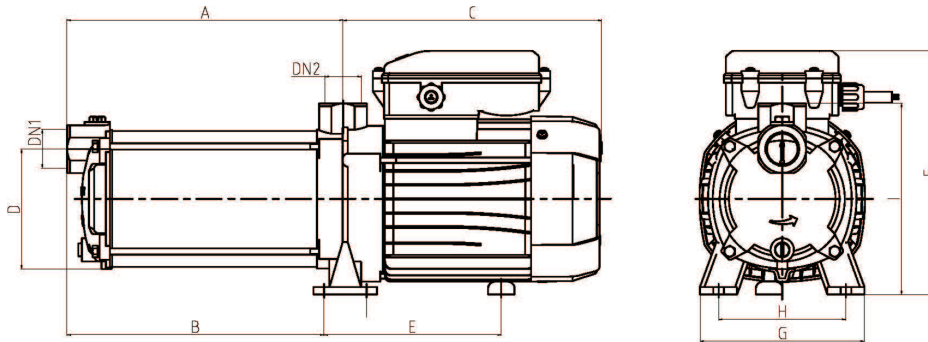

Model	DN1	DN2	Dim.(mm)									
	Inch		A	B	C	D	E	F	G	H	I	J
HPm402	1	1	171	153	222	113	144	213	155	120	170	40
HPm403	1	1	201	177	222	113	144	213	155	120	170	40
HPm404	1	1	225	201	222	113	144	213	155	120	170	40
HPm405	1	1	249	225	243	113	144	213	155	120	170	40
HPm406	1	1	273	249	243	113	144	213	155	120	170	40

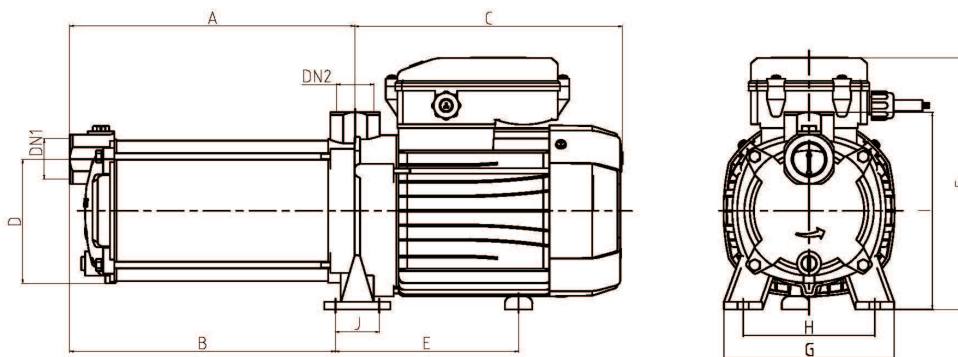

Packing Size & Weight

Model	Dim.(LxWxH) mm	G.W. (kg)	20' Loading Qty. (pcs)
HPm202	415x185x200	9.5	1512
HPm203	440x185x200	10.5	1404
HPm204	465x185x200	11.5	1296
HPm402	415x210x275	12.0	1144
HPm403	460x210x275	13.0	1120
HPm404	490x210x275	13.0	1056
HPm405	530x210x295	17.0	968
HPm406	555x210x295	19.5	896

