

Performance Curve

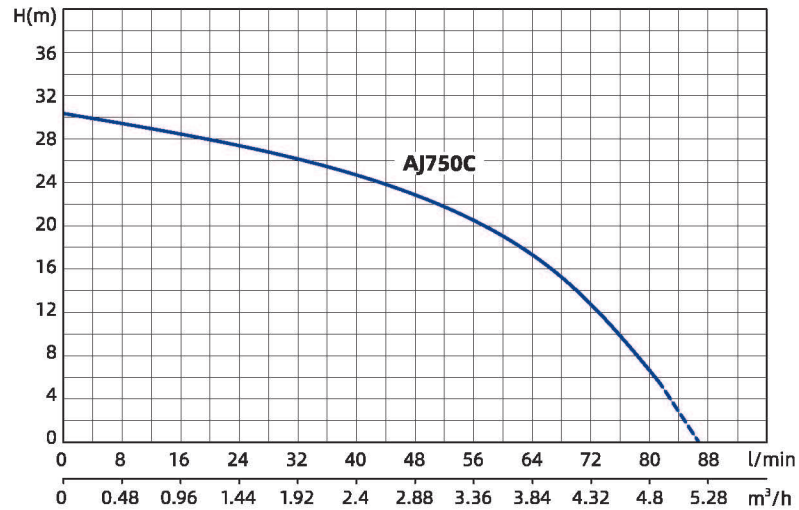

Model	Power		Max. Flow (m³/h)	Max. Head (m)	Head Range (m)	Max. Suction (m)	
	Single-Phase	kW					HP
AJ750C		0.75	1	5.1	30	30~10	8

Components & Materials

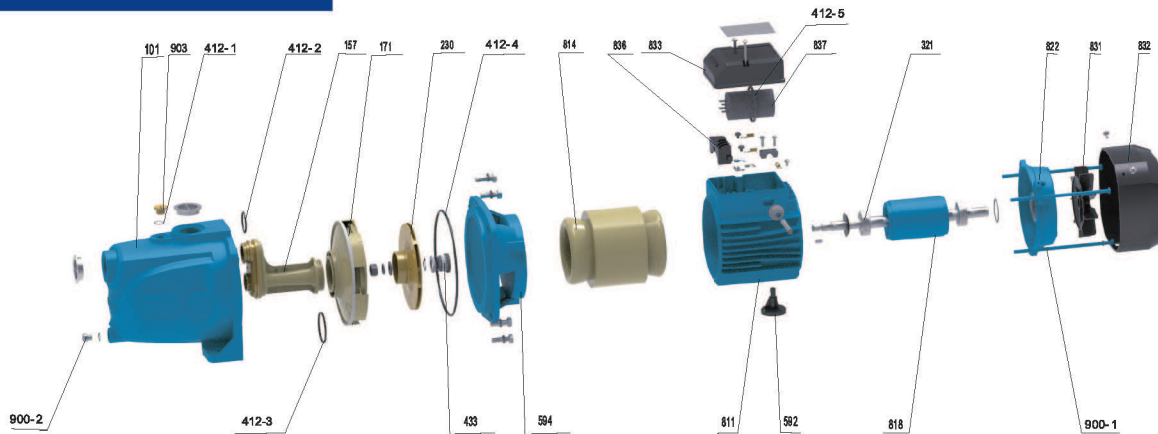

No.	Part name	No.	Part name	No.	Part name
101	Pump body	230	impeller	837	Running capacitor
412-1	O-ring	433	Machinery Seal	814	Stator core with windings
412-2	O-ring	900-1	Hexagon head bolts	811	chassis
412-3	O-ring	594	Coupling	592	Feet
412-4	O-ring	594	Coupling	818	Rotor
412-5	O-ring	822	Lower bearing block	321	Deep groove ball bearing
903	Vent cock	832	Fan cover	900-2	Slotted cheese head screws
157	Ejector	831	fan	836	Terminal block
170	Guide vane	833	Junction Box		

Model	AJ750C
Capacitor	AC20 μ F/450V
End-cover Bearing	6202-2RZ
Coupling Bearing	6202-2RZ
Motor Shaft	45 #
Mechanical Seal	301-14/21 B:A (P)(Stationary seal ring \varnothing 28) A:Hot pressed graphite,B:Reation sintered silicon carbide,P:Nitrile rubber,C:Stainless steel(06Cr19Ni10)
Motor casing	Aluminum
Coupling	Aluminum
Pump Body	HT200
Guide vane	PPO
Impeller	HPb57-3

Dimensions & Weight

Model	DN1	DN2	Dim.(mm)								N.W. (kg)	
			Inch		A	B	E	F	G	L		H1
AJ750C	1"	1"	125	167	125	151	173	420.5	131	45	202	12.0

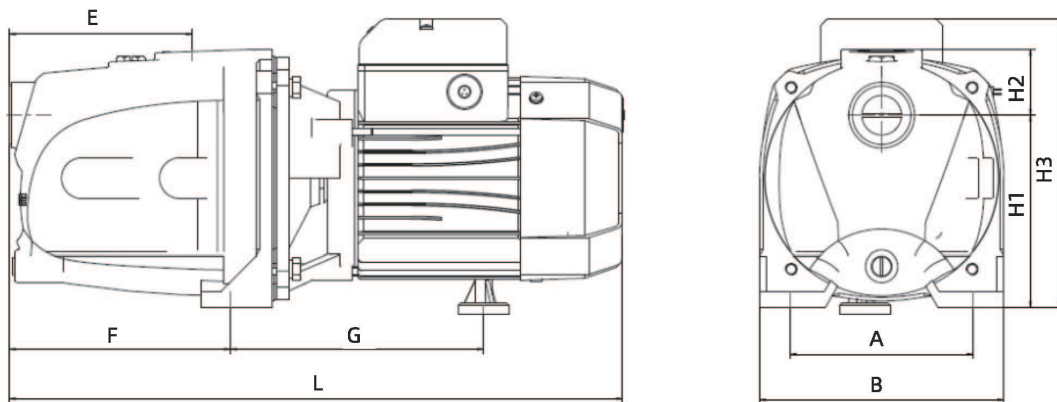

Packing Size & Weight

Model	Dim.(LxWxH) mm	G.W. (kg)	20'Loading Qty. (pcs)
AJ750C	455x205x235	12	1400

